

The Brand of BMS & Inverter



Using **PACE BMS** (software version), supporting up to 200A high current, supporting RS485 and CAN2.0 communication protocols.



Cooperative Inverter Brands:



GROWATT



TBB Power



GOODWE



LUXPOWER



DEYE

Expect cooperation Brands



Gin Long



Sofar



SRNE



Senergy



Magarevo

Configurations 1: 4.5kW PV + 5kW Inverter + Powerporter 9.0 Battery

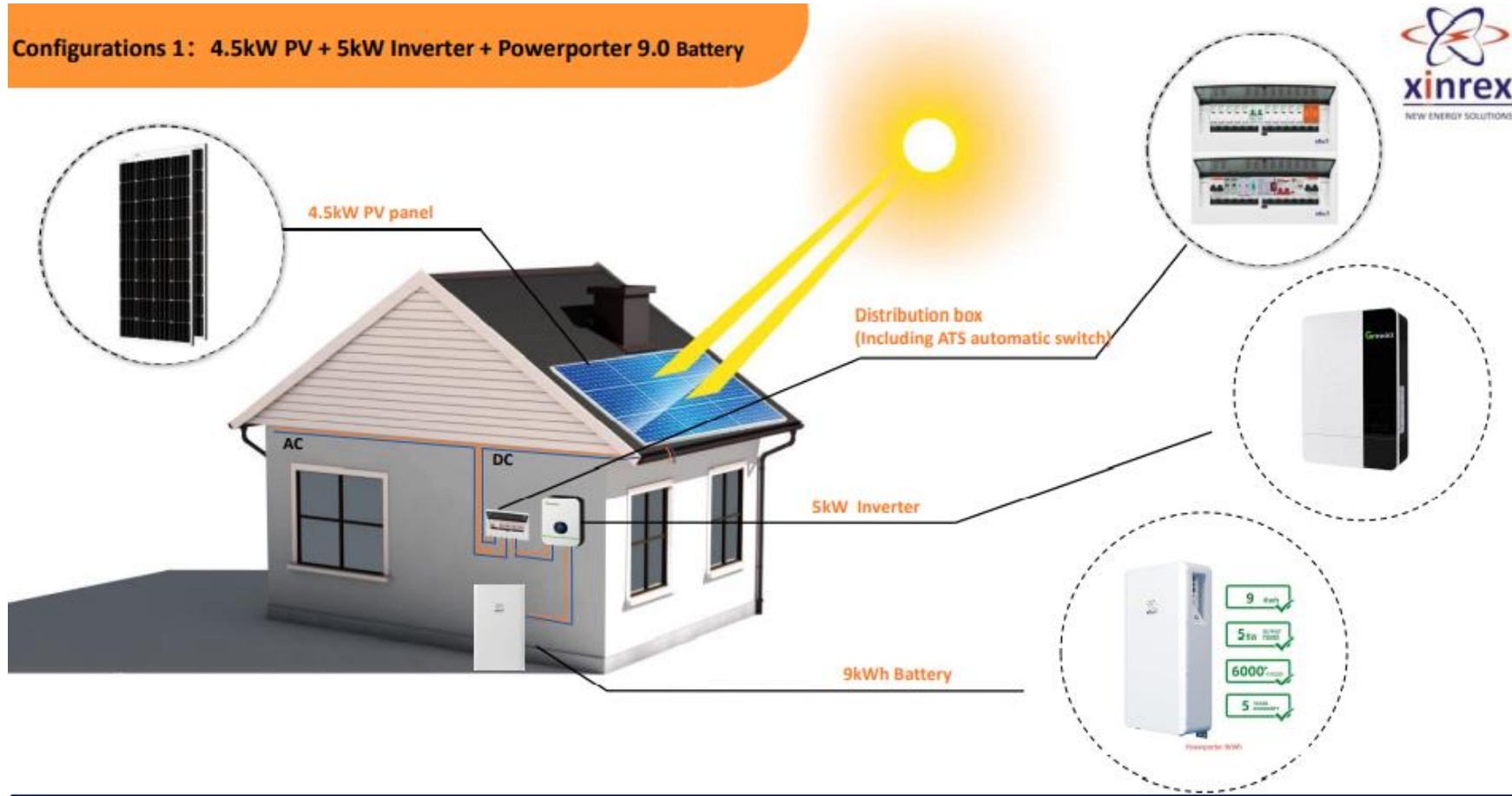

Configuration 2: 4.5kW PV + 5kW Inverter + 12.2kWh Battery

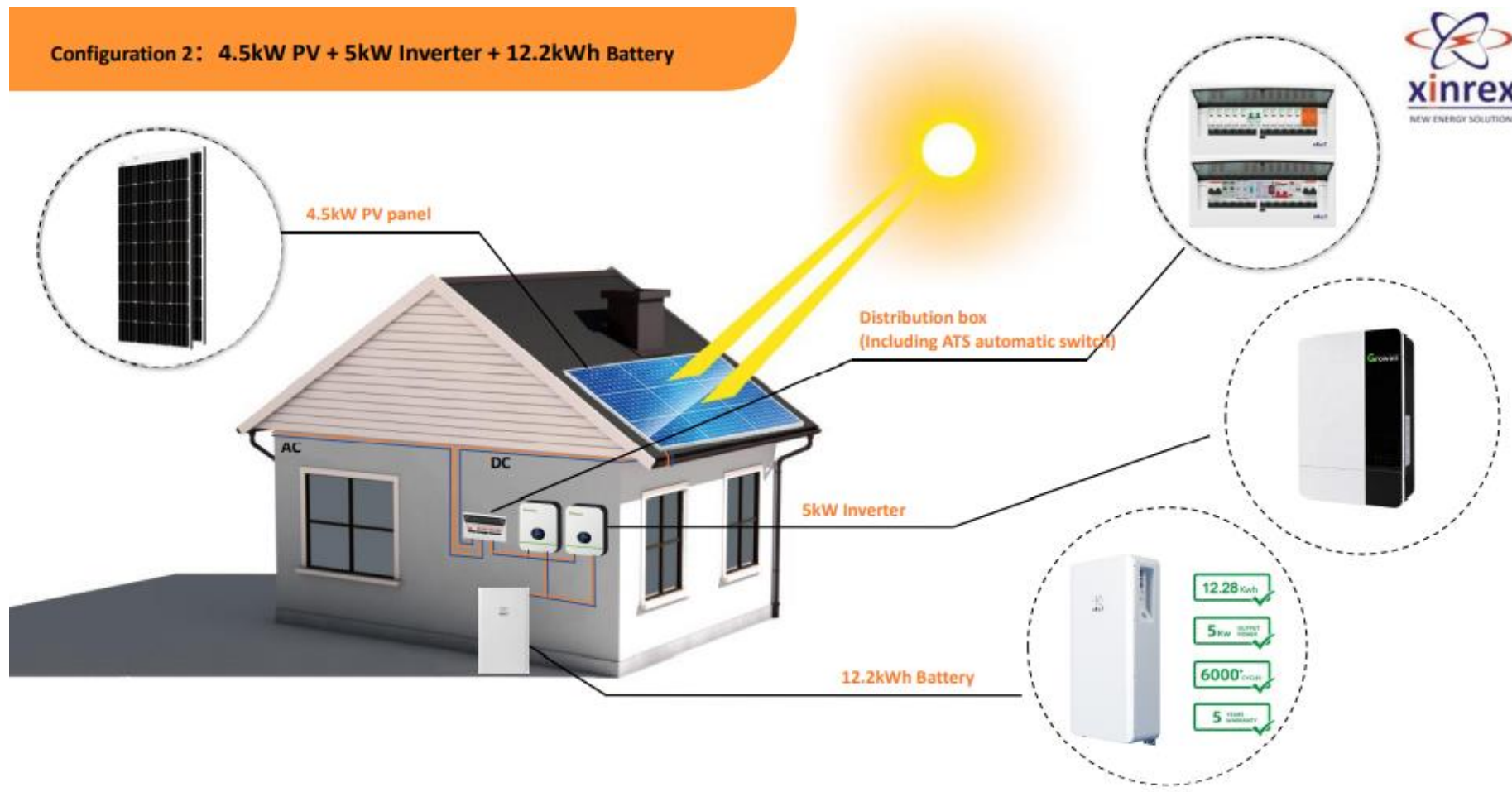

Configuration 3: 10kW PV+ 10kW Inverter + Powerporter 15.0 battery

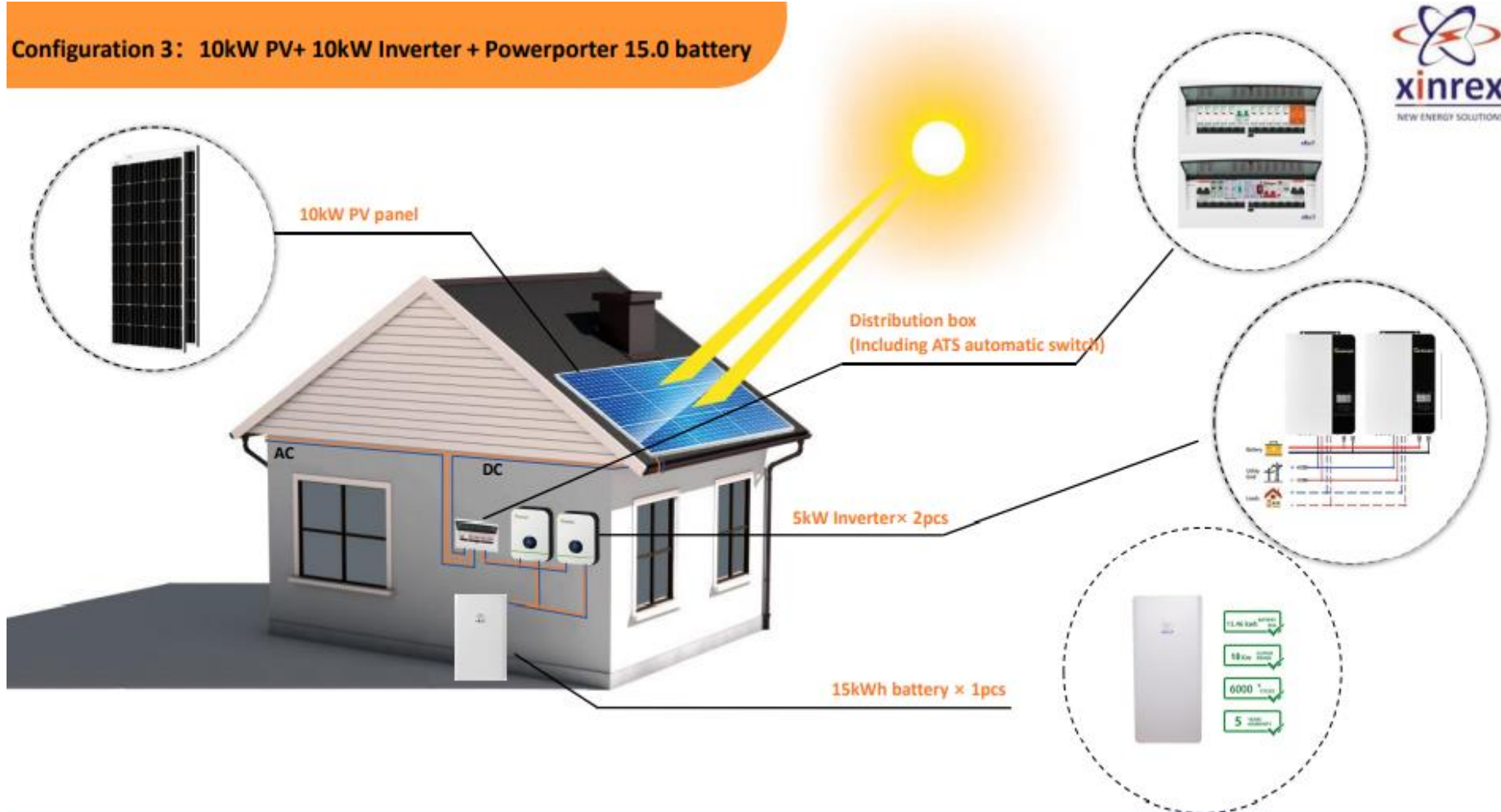



RESIDENTIAL Energy Storage System

PRODUCT INFORMATION



DONGGUAN NRUIT ENERGY TECHNOLOGY CO.,LTD

National High-Tech Enterprise

Diesel and lead acid replacement
Home smart energy management
Safe, efficient, green energy

CATL large capacity energy storage lithium iron phosphate battery

- Photovoltaic Power generation
- Wisdom energy
- Off-grid
- Power supply spare



Company Profile



Dongguan nRuit Energy Technology Co., Ltd

E&T Center: Dongguan Houjie, covering an area of 1600M2.

ESS development / Solution Test Verification/Clean Energy Application

ExperienceCenter/Energy IOT operation and Maintenance Service Center.

ESS Daily output :500 KWh Inverter Daily output : 500KW

ISO9001/14001/OHSAS certified





Some of our strategic partners



Some of our patent certificates



ESS Application development

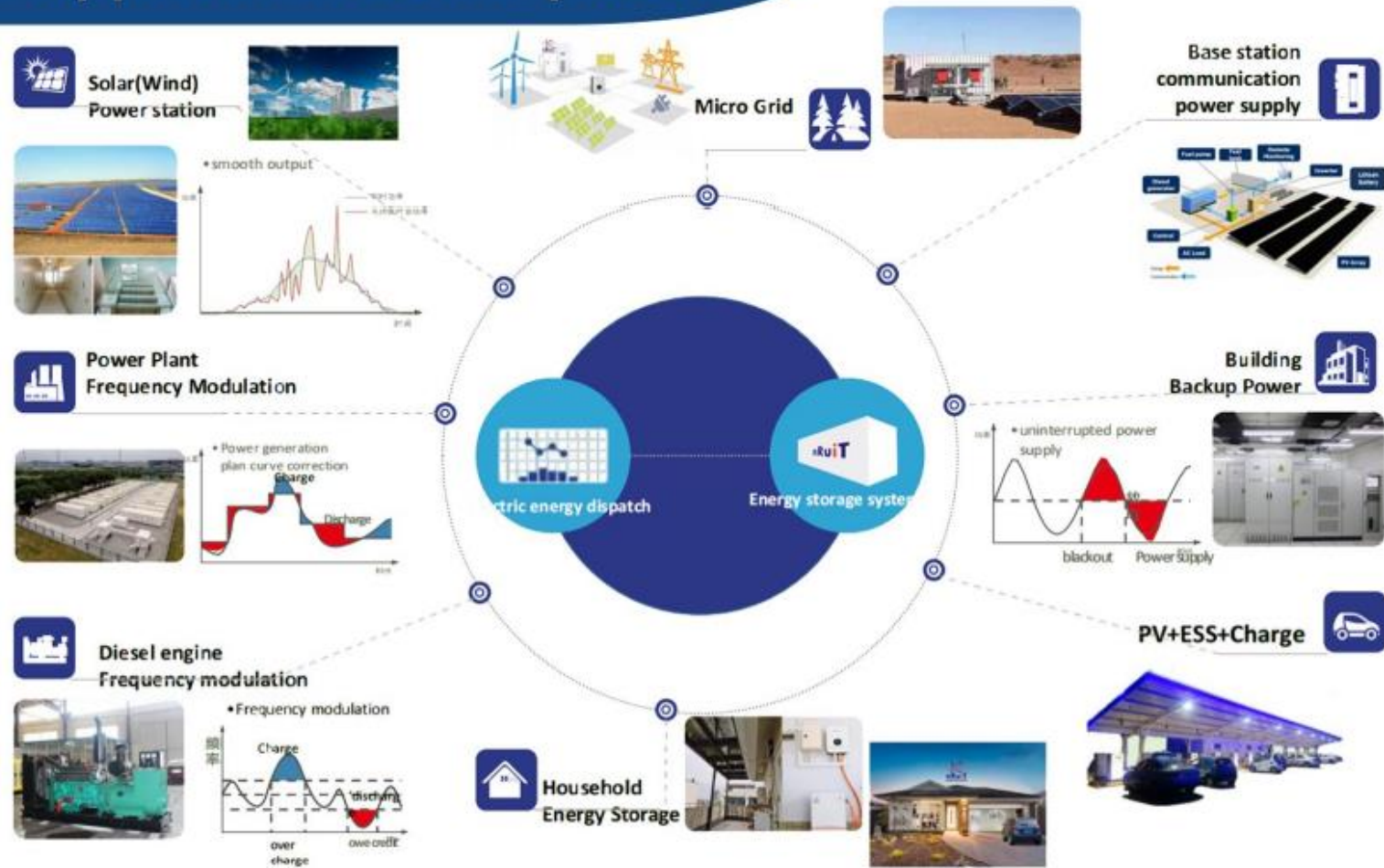



Powerporter 9.0

- Compact size
- High efficiency
- Easy installation
- High energy density

Datasheet		Powerporter 9.0
Battery Data		
Nominal Voltage		51.2V
Nominal Energy		9.0kWh
Discharge Voltage		45~54V
Charge Voltage		51.5V~54V
Cont. Charge Current		100A
Max. Charge Current		125A
Cont. Discharge Current		100A
Cont. Discharge Current		125A
Cont. Discharge DC Power		5000W
Max. Discharge DC Power		10000W/ More than 2 units in parallel
Operating temperature		0°C ~ 45°C (Charge) -20°C ~ 45°C (Discharge)
General Data		
scalability		Up to 4 units
DOD		90%
Communication		CAN2.0 / RS485
Cycle Life		> 6000
IP Grade		IP31
Installation		Wall or Floor mount
Dimension		830×460×200mm
Weight		75kg
Warranty		5 Years
UN38.3、CE		



Powerporter 12.0

- Compact size
- High efficiency
- Easy installation
- High energy density

Datasheet		Powerporter 12.0
Battery Data		
Nominal Voltage/		51.2V
Capacity		240Ah
Nominal Energy		12.28kWh
Discharge Voltage		45~54V
Charge Voltage		51.5V~54V
Cont. Charge Current		100A
Cont. Discharge Current		100A
Max. Discharge Current		125A
Cont. Discharge DC Power		5000W
Max. Discharge DC Power		10000W/ More than 2 units in parallel
Operating temperature		0°C ~ 45°C (Charge) -20°C ~ 45°C (Discharge)
General Data		
scalability		Up to 4 units
DOD		90%
Communication		CAN2.0 / RS485
Cycle Life		> 6000
IP Grade		IP31
Installation		Wall or Floor mount
Dimension		900×460×200mm
Weight		112kg
Warranty		5 Years
UN38.3、CE		



Powerporter 15.0

- Compact size
- High efficiency
- Easy installation
- High energy density

Datasheet		Powerporter 15.0
Battery Data		
Nominal Voltage/		51.2V
Capacity		302Ah
Nominal Energy		15.46kWh
Discharge Voltage		45~54V
Charge Voltage		51.5V~54V
Cont. Charge Current		200A
Cont. Discharge Current		200A
Max. Discharge Current		230A
Cont. Discharge DC Power		10000W
Max. Discharge DC Power		30000W/ More than 4 units in parallel
Operating temperature		0°C ~ 45°C (Charge) -20°C ~ 45°C (Discharge)
General Data		
scalability		Up to 4 units
DOD		90%
Communication		CAN2.0 / RS485
Cycle Life		> 6000
IP Grade		IP31
Installation		Floor mount
Dimension		980×460×230mm
Weight		120kg
Warranty		5 Years
UN38.3、CE		

Intelligent Power Mate, 24-hour, Uninterrupted Power Supply



Home



Office



Farm



Hotel



PORTABLE
SAFETY
LONG LIFE

**Commit to Provide Clean, Safe
and Intelligent New Energy Solution!**

Various capacity to meet your need!



TITANS

HIGH PERFORMANCE
MONOCRYSTALLINE PERC MODULE

RSM40-8-385MB-405MB

120 CELL
Mono PERC Module

385-405Wp
Power Output Range

1500VDC
Maximum System Voltage

21.1%
Maximum Efficiency



KEY SALIENT FEATURES

- Global, Tier 1 bankable brand, with independently certified state-of-the-art automated manufacturing
- Industry leading lowest thermal co-efficient of power
- Industry leading 15 years product warranty
- Excellent low irradiance performance
- Excellent PID resistance
- Positive tight power tolerance
- Dual stage 100% EL Inspection warranting defect-free product
- Module Imp binning radically reduces string mismatch losses
- Excellent wind load 2400Pa & snow load 5400Pa under certain installation method
- Comprehensive product and system certification
 - + IEC61215:2016, IEC61730-1/-2:2016;
 - + ISO 9001:2015 Quality Management System
 - + ISO 14001:2015 Environmental Management System
 - + ISO 45001:2018 Occupational Health and Safety Management System



* As there are different certification requirements in different markets, please contact your local Risen Energy sales representative for the specific certificate applicable to the products in the region in which the products are to be used.

RISEN ENERGY CO., LTD.

Risen Energy is a leading, global tier 1 manufacturer of high-performance solar photovoltaic products and provider of total business solutions for residential, commercial and utility-scale power generation. The company, founded in 1988, and publicly listed in 2010, competes value generation for its chosen global customers. Techno-commercial innovation, underpinned by consummate quality and support, secures Risen Energy's total Solar PV business solutions which are among the most powerful and cost-effective in the industry. With local market presence and strong financial bankability status, we are committed, and able, to building strategic, mutually beneficial collaborations with our partners, as together we capitalise on the rising value of green energy.

Texian Industry Zone, Wujin, Ningbo 315009 Ningbo | PRC
Tel: +86-574-59953239 Fax: +86-574-59953899
E-mail: marketing@risenenergy.com Website: www.risenenergy.com



LINEAR PERFORMANCE WARRANTY

15 year Product Warranty | 25 year Linear Power Warranty



THE POWER OF RISING VALUE

TITANS

Dimensions of PV Module

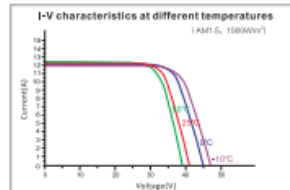
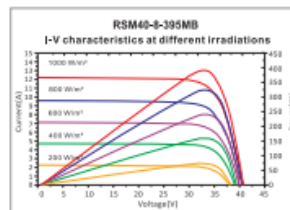
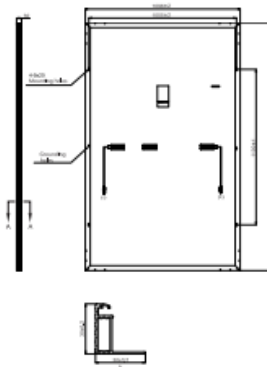

Our Partners:

RSM40-8-385MB-405MB-2021-AU

ELECTRICAL DATA (STC)

Model Number	RSM40-8-385MB	RSM40-8-390MB	RSM40-8-395MB	RSM40-8-400MB	RSM40-8-405MB
Rated Power in Watts-Pmax(Wp)	385	390	395	400	405
Open Circuit Voltage-Voc(V)	40.38	40.69	41.00	41.30	41.60
Short Circuit Current-Isc(A)	12.15	12.21	12.27	12.34	12.40
Maximum Power Voltage-Vmp(V)	33.62	33.88	34.14	34.39	34.64
Maximum Power Current-Imp(A)	11.46	11.52	11.58	11.64	11.70
Module Efficiency (%) *	20.0	20.3	20.5	20.8	21.1

STC: Irradiance 1000 W/m², Cell Temperature 25°C, Air Mass AM1.5 according to EN 60904-3.
* Module Efficiency (%): Round-off to the nearest number

ELECTRICAL DATA (NMQT)

Model Number	RSM40-8-385MB	RSM40-8-390MB	RSM40-8-395MB	RSM40-8-400MB	RSM40-8-405MB
Maximum Power-Pmax (Wp)	291.8	295.6	299.4	303.1	306.9
Open Circuit Voltage-Voc (V)	37.55	37.84	38.13	38.41	38.69
Short Circuit Current-Isc (A)	9.96	10.01	10.07	10.12	10.17
Maximum Power Voltage-Vmp (V)	31.20	31.44	31.68	31.91	32.15
Maximum Power Current-Imp (A)	9.35	9.40	9.45	9.50	9.55

NMQT: Irradiance at 800 W/m², Ambient Temperature 20°C, Wind Speed 1 m/s.

MECHANICAL DATA

Solar cells	Monocrystalline
Cell configuration	120 cells (5×12×5×12)
Module dimensions	1754×1096×30mm
Weight	21kg
Superstrate	High Transmission, Low Iron, Tempered ARC Glass
Substrate	Back-sheet (Front side: Black, Back side: White)
Frame	Anodized Aluminium Alloy type 6005-2T6, Black
J-Box	Potted, IP68, 1500VDC, 3 Schottky bypass diodes
Cables	4,0mm² (12AWG), Positive(+)-350mm, Negative(-)-350mm (Connector Included) or Customized length
Connector	Risen Twinsel PV-SY02 or MC4 EVO2, IP68

TEMPERATURE & MAXIMUM RATINGS

Nominal Module Operating Temperature (NMQT)	44°C±2°C
Temperature Coefficient of Voc	-0.25%/°C
Temperature Coefficient of Isc	0.04%/°C
Temperature Coefficient of Pmax	-0.34%/°C
Operational Temperature	-40°C→+85°C
Maximum System Voltage	1500VDC
Max Series Fuse Rating	20A
Limiting Reverse Current	20A

PACKAGING CONFIGURATION

	40ft(HQ)	20ft
Number of modules per container	936	180
Number of modules per pallet	36	36
Number of pallets per container	26	5
Box gross weight[kg]	805	805

CAUTION: READ SAFETY AND INSTALLATION INSTRUCTIONS BEFORE USING THE PRODUCT.
©2021 Risen Energy. All rights reserved. Contents included in this document are subject to change without notice.
No special undertaking or warranty for the suitability of special purpose or being installed in extraordinary surroundings is granted unless otherwise specified by the manufacturer in contract documents.

THE POWER OF RISING VALUE